

CENSTM

PROFLEX

DX SERIES



User Guide

Contains important information - do not throw away

CENS® ProFlex digital

Category III Personal Protective Equipment (PPE) manufactured by Puretone Ltd for protection against the harmful effects of noise.

EU Type Tested to harmonized standards EN352-2:2002, EN352-7:2002 and certified in conformity with the provisions of Regulation (EU) 2016/425 including ongoing surveillance (Module D) by SATRA Technology Europe Ltd, Bracetown Business Park, Clonee, Co. Meath, Ireland D15 YN2P (Notified Body 2777).

EU declaration of conformity can be accessed at www.puretone.net

Disposal Information

Within the European Union, the marked equipment is covered by "Directive 2002/96/EC of the European Parliament and of the Council of 27 January 2003 on waste electrical and electronic equipment." Amended by "Directive 2003/108/EC" (WEEE).

Recycle CENS® ProFlex, batteries and accessories according to national regulations.

Symbols used in this guide

Be aware of information marked with the warning symbol
WARNING, CAUTION or NOTICE!



WARNING points out a situation that could lead to serious injuries.

CAUTION **CAUTION** indicates a situation that could lead to minor and moderate injuries.

NOTICE **NOTICE** indicates possible property damage.



Advice and tips on how to handle your device better.



Instruction. Indicates that something has to be done.

Contents

Your CENS ProFlex	4
Intended Use	5
General Notes On Safety	6-7
Handling Batteries	8
Setup	9
Modules	10
Cleaning and Disinfection	11
Earpiece Insertion	12
Earpiece Fitting	13
Earpiece Removal	13
Turning Your CENS ProFlex On & Off (All Models)	14
Adjusting The Volume (DX1)	15
Adjusting The Volume & Modes (DX3/DX5)	16
Troubleshooting	17
Technical Information	18-19

Your CENS ProFlex

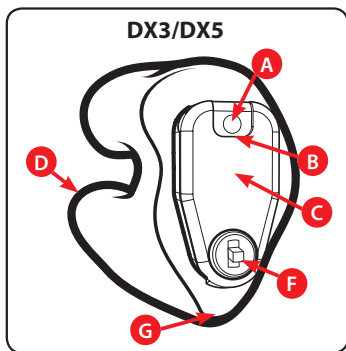
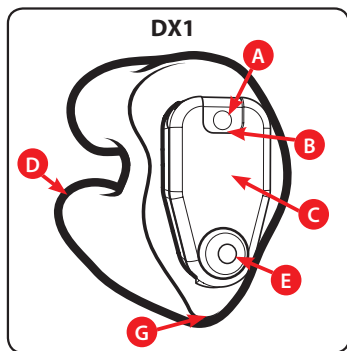

- | | |
|------------------------|--|
| A On/off button | D Clear tip |
| B Microphone | E Digital push button volume control (DX1) |
| C Battery lid | F Digital multi-switch volume control & mode select (DX3/DX5) |
| G Ear indicator | |
- LEFT EAR RIGHT EAR

Every CENS ProFlex can be identified by the serial number located on the underside of the module. The intended users name (personal ID) will be laser marked onto each custom-made silicone earpiece.



DX1, DX3 & DX5 are provided with level-dependent attenuation. The wearer should check correct operation before use. If distortion or failure is detected, the wearer should refer to the manufacturers advice for maintenance and replacement of the battery.

Intended Use

CENS ProFlex is intended to protect your hearing while being able to communicate normally or hear better. To ensure the best possible protection it has to be used constantly in noisy situations.

CENS ProFlex are reusable devices with a level dependent function. The volume control function of CENS ProFlex is designed to allow a small increase in low level ambient sound, affording the user increased awareness in sporting situations.

CENS ProFlex are not intended or suitable for use as a hearing aid or to provide any correction for hearing loss.

Read and follow the instructions of this user guide before use to avoid possible injuries or damage.

It is recommended that the wearer should ensure the CENS ProFlex ear-plugs:

- ▶ are fitted, adjusted and maintained in accordance with the manufacturer's instructions.
- ▶ are worn at all times in noisy surroundings.
- ▶ are regularly inspected for serviceability.



If the above recommendations are not adhered to, the protection afforded by the CENS ProFlex will be severely impaired.

General Notes On Safety

NOTICE Your CENS ProFlex is sensitive to extreme heat, high humidity, strong magnetic fields ($>0.1T$), X-rays and mechanical stress.

- ▶ Do not expose your CENS ProFlex to extreme temperatures or high humidity.
- ▶ Do not leave your CENS ProFlex in direct sunlight.
- ▶ Do not wear your CENS ProFlex in the shower or when you apply make-up, perfume, aftershave, hairspray or suntan lotion.
- ▶ Do not wear your CENS ProFlex when you are exposed to short-waves, a strong magnetic field, a high frequency field or X-rays.
- ▶ Do not place your CENS ProFlex in a microwave oven.



Choking hazard posed by small parts.



Performance may deteriorate with battery usage. The typical period of continuous use that can be expected from the earpiece is up to 400 hours (see page 8 for more information).



The output of the level-dependent circuit of this hearing protector may exceed the daily limit sound level.

- ▶ Keep CENS ProFlex, batteries and accessories out of children's reach.
- ▶ If swallowed consult a physician or hospital immediately.
- ▶ If infants, small children or disabled persons need to wear CENS ProFlex ensure adequate supervision.

NOTICE



Leaking batteries will damage the CENS ProFlex.



Turn the CENS ProFlex off when not in use to preserve the battery.



Remove batteries when the instruments are not in use for a prolonged period of time.

NOTICE



Batteries contain harmful substances that pollute the environment.



Do not throw used batteries into household waste.



Dispose batteries according to national regulations or return them to your supplier.



Hazard of explosion!



Do not use your CENS ProFlex in areas where there is a danger of explosions (e.g. mining).



These are reusable devices, and it is strongly recommended that they are regularly inspected to ensure correct fit and functionality. If in doubt, return them for a service and check.



Puretone recommend CENS ProFlex electronic modules should be returned for manufacturer service and inspection annually.

Handling Batteries

Your CENS ProFlex uses a size 13 Zinc-Air battery. The packaging/tab for this size battery will usually be identified by the colour orange.



Typical battery life is up to 400 hours, but will vary depending on ambient sound levels and environmental conditions such as humidity.

Please note: Once a Zinc-Air battery tab has been removed, battery life will not typically exceed 45 days. The battery will dry out and no longer be effective.



- ▶ Always use the correct size of batteries, as supplied with your CENS model.
- ▶ Remove the tab on your batteries only when you are ready to use them.
- ▶ The positive (+) side of the batteries is always the smooth side.
- ▶ Always keep spare batteries with you.



Low Battery Warning

DX1 you will hear a series of 3 beeps repeated every 5 minutes until the device shuts down or the battery is replaced.

DX3/DX5 you will hear a vocal warning “battery low” every 10 minutes. When the battery reaches low you will hear a series of 6 double beeps, this will be followed by the device shutting down.

If the battery fails during use and is not replaced, your protection will not be compromised, but the ambient awareness will deteriorate.

Setup

Module Insertion

- ▶ Press modules into earpieces until they snap into place.
- ▶ Modules can be used in either the Left or Right earpiece.

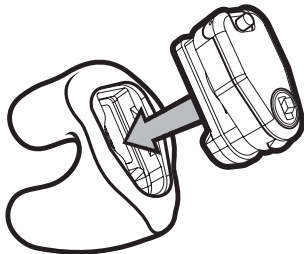

Inserting The Battery

- ▶ Ensure battery tabs have been removed, open the battery lid. Place the new battery on the magnet stick as shown.
- ▶ Insert the battery into the module bottom first, as shown in the diagram, and then tilt the stick up to insert the top of the battery.
- ▶ Finally, remove the battery stick from the new battery, and close the battery lid.

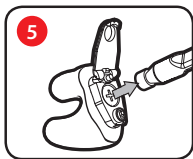
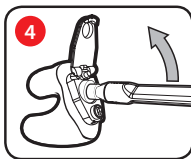
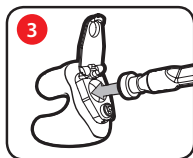
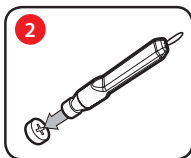
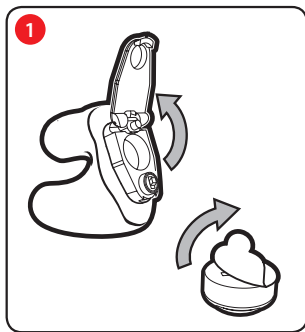

Removing The Battery

- ▶ Open the battery lid. Place the magnet stick on the battery and remove directly out.

Modules

CENS ProFlex digital custom electronic noise suppressors are designed with a removable modular format for ease of use, easier cleaning and maintenance.

The module is designed to snap fit into the preformed silicone earpiece.

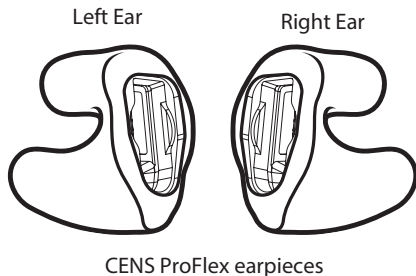

Electronic Modules



Interchangeable Passive
Filter Module

Order Code: CENS-PF-PAS

NOTICE



Do not use the lid to extract the module from silicone earpiece.



Do not use excessive force when inserting or removing.



Do not use the earpieces without a module (passive or electronic) fitted.



CENS ProFlex is a 2 part modular system. For optimal protection the module and silicone earpiece must be inserted correctly as described on page 12.

Cleaning and Disinfection

It is recommended that you clean your CENS ProFlex digital after every use to keep them in perfect working condition.

Remove the module from the earpiece before cleaning.

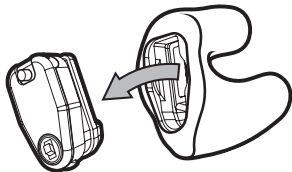

Use the brush to clean the sound hole.

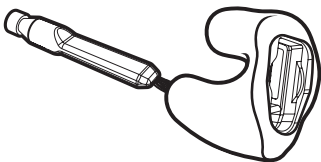

Your CENS ProFlex is a highly sensitive system. Proper care and handling will ensure the best possible performance. Clean the instrument regularly to prevent damage to the CENS ProFlex and to avoid health problems.

NOTICE

- ▶ Do not put the CENS ProFlex in water.
- ▶ (Remove module) use the supplied air puffer to blow debris out of the sound tube on the earpiece then clean with the brush and wipe with a damp cloth.
- ▶ Use a **dry soft cloth** to wipe the module being careful not to touch the rubber underneath where sound is delivered.
- ▶ Ask your supplier for special care packs and further information on how to keep your CENS ProFlex in good condition.
- ▶ This product may be adversely affected by certain chemical substances, *e.g insect repellents containing DEET*. Further information should be sought from the manufacturer.



NOTICE

Always transport and store your CENS ProFlex in the protective case supplied.

Earpiece Insertion



It is important that each device is fitted correctly to ensure safe and effective use. To check the fit is correct, clap your hands near each ear (ensure the electronic modules are switched off). You should hear the sound but at a lower level.

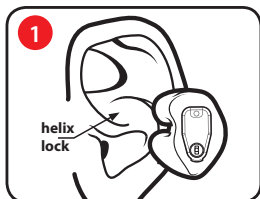

Rotate the earpiece forward 45°–90°.

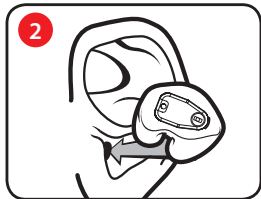

Place the earpiece into your ear canal. Pull the top of your ear with your opposite hand for easier insertion.



Rotate the earpiece backward & inward into its upright position to fully seat the earpiece in your ear canal. Make sure the top portion of the earpiece fits into the helix lock of your ear.

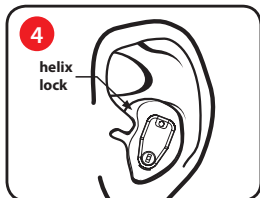

You will feel the earpiece lock into place once properly fitted.

Earpiece Fitting

Correct Fitting



Earpiece is flush and helix is securely in the ear.

Incorrect Fitting



Earpiece is not flush and helix is not correctly in the ear.

Earpiece Removal

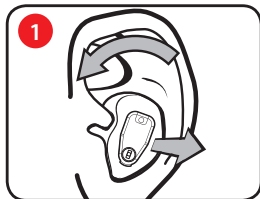

Grasp the earpiece and rotate it forward while pulling outward. Do not grasp the module. Pulling the top of the ear slightly may ease removal.



Remove the earpiece and store safely.

NOTICE

Never pull on the battery compartment lid or volume controls to remove the CENS ProFlex, as this could cause damage.



Sudden or fast removal of ear-plugs from the ear canal may damage the ear drum.

Turning Your CENS ProFlex On & Off



All controls must be operated with the battery lid closed.

The on/off button is located at the top of the electronic module.

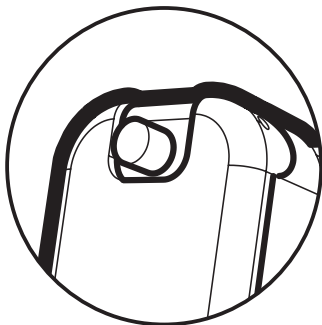

Push and release once to toggle on and off.



DO NOT use your CENS ProFlex earpieces without either the electronic or passive module being fitted.



Once the devices are switched on, you will be able to hear sound as normal; however, when a loud sound is detected the device will automatically reduce the volume to a safe and comfortable level. After the loud sound has passed the volume is automatically returned to normal.

Please note:

DX1 there will be a 0.5s delay followed by a start up melody.

DX3/DX5 instant start followed by voice indicator prompting the current mode setting.

Adjusting The Volume (DX1)

CAUTION

- ▶ Never use your device on a higher volume setting than is comfortable.
- ▶ All controls must be operated with the battery lid closed.

NOTICE The volume control must only be operated by your finger tips with light pressure. Applying excessive pressure can result in the volume control being damaged. This is a precision miniature device that must be handled with care.

The volume control push button is located at the bottom of the electronic module.

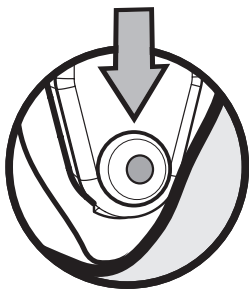

Short press to cycle through the three volume levels.

Adjusting The Volume & Modes (DX3/DX5)

CAUTION

- ▶ Never use your device on a higher volume setting than is comfortable.
- ▶ All controls must be operated with the battery lid closed.

NOTICE The digital multi-switch must only be operated by your finger tips with light pressure. This is a precision miniature device that must be handled with care.

The digital multi-switch is located at the bottom of the electronic module.

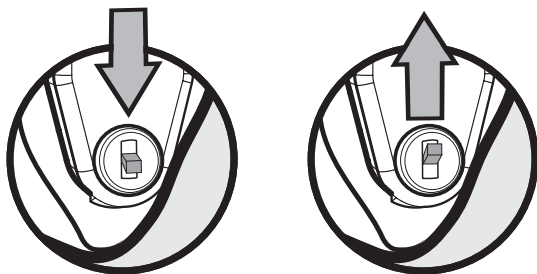

Short press up - increases the volume level
Short press down - decreases the volume level

Long press up - increments mode select
Long press down - decrements mode select

Troubleshooting

Use these tips to resolve simple issues.

Problem	Possible Solution
Sound is weak.	Replace empty battery. Increase volume. Clean instrument. Close battery door completely.
CENS ProFlex emits whistling sounds.	Reinsert the instrument until it fits securely. Clean instrument.
Sound is distorted.	Replace empty battery. Lower volume. Clean instrument.
CENS ProFlex emits signal tones.	Gently close battery compartment completely. Replace empty battery.
CENS ProFlex does not work.	Check if the CENS ProFlex is turned on. Gently close battery compartment completely. Replace empty battery. Make sure battery is inserted correctly.
Ambient sound not as expected.	Check same mode selected for left and right device.

Consult your supplier if you encounter further problems.

Technical Information (EN352)

Electronic Module - Sound Attenuation

Frequency (Hz)	63	125	250	500	1000	2000	4000	8000
Mean Attenuation	26.1	24.6	23.2	23.3	23.4	31.6	31.8	36.4
Standard Deviation	6.4	4.6	3.8	3.5	3.4	3.6	3.3	4.8
Assumed Protection	19.7	20.0	19.4	19.8	20.0	28.0	28.5	31.6

H=27

M=21

L=20

SNR=25

Criterion Levels

Program No.	H	M	L
1	111	105	105
2	112	106	105
3	111	106	104
4	112	106	105

SNR = Single Number Rating attenuation
 H = High frequency attenuation
 M = Medium frequency attenuation
 L = Low frequency attenuation

Passive Module - Sound Attenuation

Frequency (Hz)	63	125	250	500	1000	2000	4000	8000
Mean Attenuation	24.2	23.5	22.3	22.8	23.5	32.1	30.4	36.8
Standard Deviation	4.5	3.6	2.8	3.8	3.4	3.8	3.8	5.6
Assumed Protection	19.7	19.9	19.5	19.0	20.1	28.3	26.6	31.2

H=26

M=21

L=20

SNR=25

EN352-2:2002, EN352-7:2002, Regulation (EU)2016/425 Module D by
 SATRA Technology Europe Ltd, Bracetown Business Park, Clonee, Co. Meath,
 Ireland D15 YN2P (Notified Body 2777)



Designed and manufactured in the UK



Puretone Ltd, 9-10 Henley Business Park,
Trident Close, Medway City Estate, Rochester,
Kent. ME2 4FR. UK.

CENS® is a registered trademark of Puretone Ltd

CENS® module is protected by EC Design Registration No. 001861998-0001

Norwegian Design Registration No. 083344

South African Design Registration No. 2011/01813

US Design Patent D739,946 S.